

REBEL

RA3600W



3600W

D
Class

- 1 channel amplifier, Class D
- Great price vs performance ratio
- Heavy and efficient heatsink for "Best in class" reliability & performance
- Variable 12dB / Octave crossovers
- 4 Way Protection Circuit
- Remote subwoofer level control included
- Bridge function between two RA3600W

Product Specifications

Total Power:	3600W MAX
Power (1 ohm):	1x1800W RMS *
Power (2 ohm):	1x1200W RMS *
Power (4 ohm):	1x700W RMS *
S/N ratio:	95dB
Freq. response:	15Hz - 200Hz
Low Pass filter:	50Hz - 200Hz
Subsonic filter:	OFF - 50Hz
Bass boost:	0 - 12 dB (45Hz)
Input adjustment	0.2V - 8V
Voltage:	10V - 16V
Protect:	Short Circuit protection
	Overload protection
	DC protection
	Thermal protection

* RMS Power at 14.4 V, THD 1%

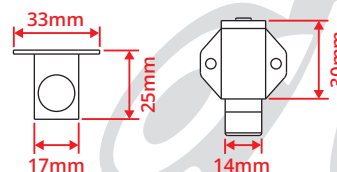
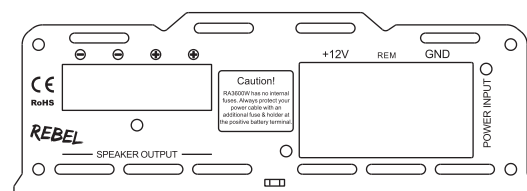
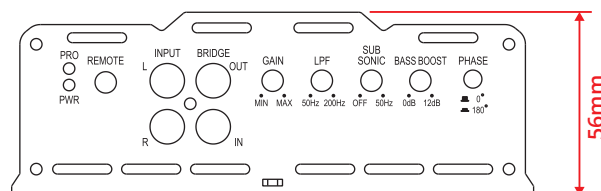
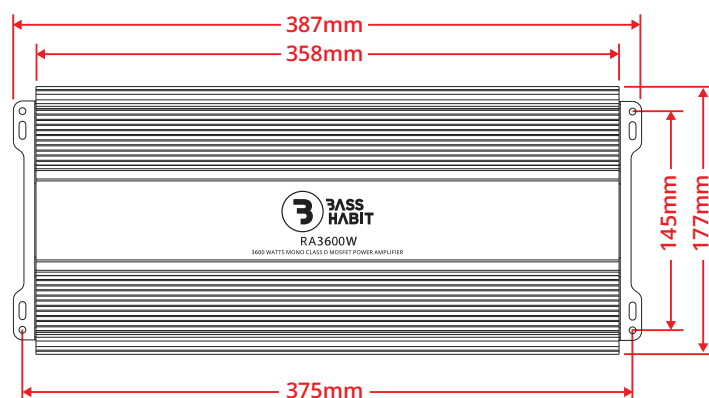

Recommended 12V+ cable	Recommended REM cable	Recommended GND cable	Recommended fuse rating
1 AWG / 50mm ²	18-10 AWG / 0.75-6mm ²	1 AWG / 50mm ²	150A